

Philip Estes

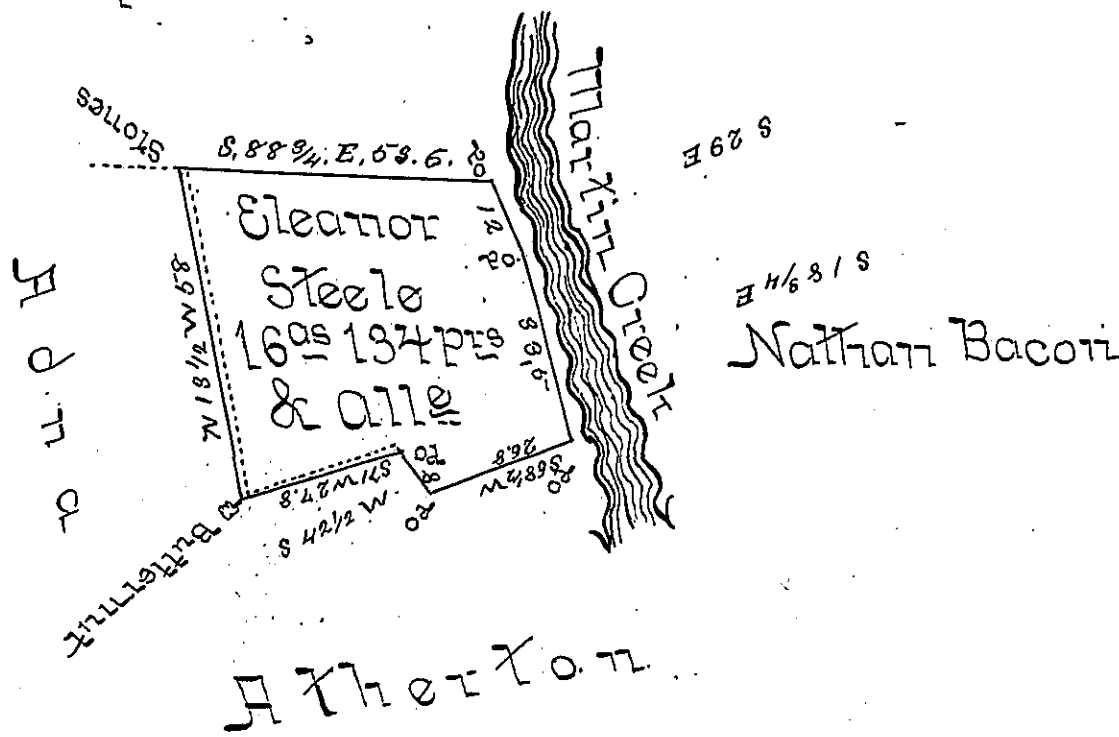

Draft of a tract of improved land situate in the town-  
 ship of Nicholson in the County of Wyoming containing  
 sixteen acres and one hundred and thirty four perches and  
 allowance of six per cent &c.

Surveyed the above described tract of land the 11<sup>th</sup> day  
 of November 1851 for Eleanor Steele by virtue of her  
 warrant dated the first day of November AD 1851.

To J. P. Brawley Esq<sup>r</sup>  
 Surveyor General

A. Hines D.S.

Adna Atherton who adjoins the above survey on  
 the south and west claims about 1/8<sup>s</sup> of an acre - the  
 dotted lines show the interference

A. Hines

*IN TESTIMONY* that the above is a copy of the original remaining on file in the  
 Department of Internal Affairs of Pennsylvania, made con-  
 formably to an Act of Assembly approved the 16th day of  
 February, 1833, I have hereunto set my Hand and caused  
 the Seal of said Department to be affixed at Harrisburg, this  
second day of November 1897.

*James W. Patton*  
 Secretary of Internal Affairs.